



2002+ Chevy Trail Blazer, GMC Envoy, Buick Ranier, Olds Bravada, Isuzu Ascender QuickLIFT Installation Guide

Step 1 - Unpack QuickLIFT kit and verify contents.

Remove all items from the packing tube. You should have the following before beginning:

- * (2) Gas springs (**RT-QL-200-7A**) - Be sure to cycle them a few times before installing.
- * (8) 3/16" #1 Steel Rivets
- * (4) Steel brackets - 2 fender, 2 hood.
- * Printed Color Instructions



Step 2 - Gather the required tools.

Please gather the following tools before you begin the installation:

- * Power Drill
 - * Sharp 3/16" drill bit
 - * Fine permanent marker or felt tip pen
 - * Tape Measure or ruler
 - * Masking Tape
 - * Hammer & center punch
 - * Rivet gun, capable of 3/16" rivets (most brands can handle this size)
- Note:** Only use the rivets supplied in the QuickLIFT kit.



Recommended: Craftsman standard or Swivel Riveter (shown - 974749) - \$9.99 to \$17.99

Step 3 - Mark centerlines of brackets.

- A. Leave your hood closed.
- B. Using a piece of masking tape and a permanent marker, carefully measure from the hood's corner (near hinge and windshield) and along the fender line. Wrap the end of the tape measure over the corner lip and place a mark on the fender masking tape at **11-3/4"**.
- C. Next, place a mark on the hood masking tape at **27-1/4"**.

These marks will be used to align the centerlines of the ball-stud brackets in the next steps.

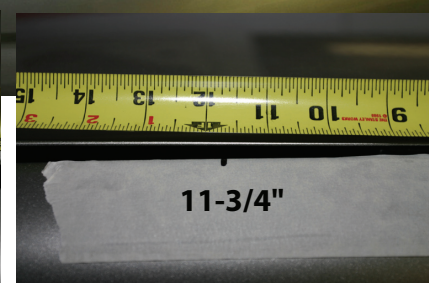
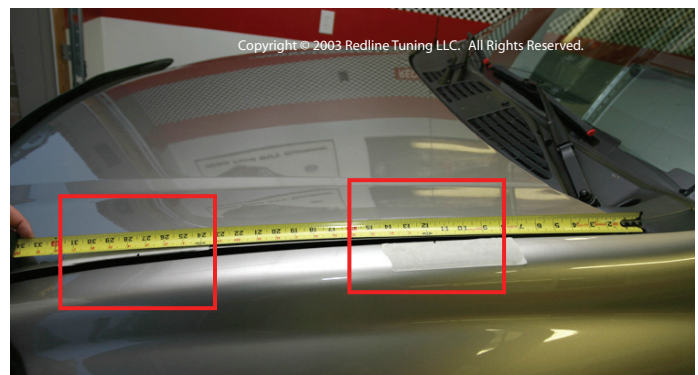

Step 4 - Align bracket and mark right hole for drilling.

A. Align the center of the bracket with the mark you just made on the hood. You will need to view the hood directly from the side as shown in **Figure 4A**. The bracket should sit on the angled hood frame tucked up against the hood skin with the ball stud facing down or toward the engine (**Figure 4B**).

B. Holding bracket in place, mark the center of the hole using a permanent felt tip marker. Be sure the bracket is straight as described above.

C. Set bracket aside. Using a center punch and a hammer, tap the center of the mark you just made (this indentation

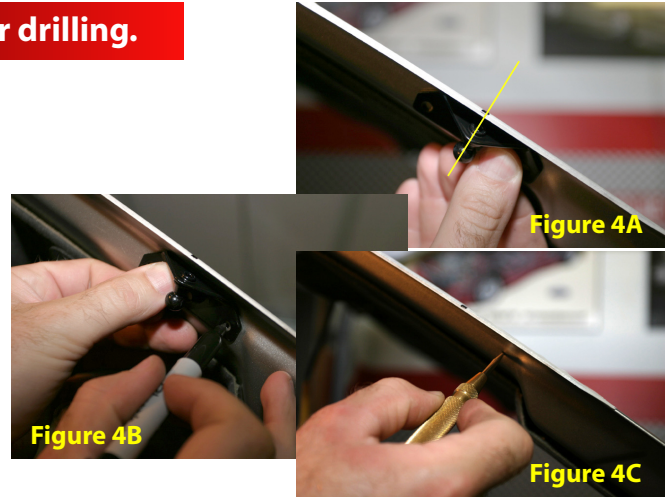

Step 5 - Drill 3/16" hole.

A. Carefully drill the hole as shown to the right using a **3/16" bit**.

Wrap a piece of electrical tape around the drill bit about 1/4" from the tip to prevent the bit from denting the hood skin. Use new and sharp bits! A drill stop can be used if you have this tool.



Step 6 - Rivet bracket to hood.

A. Hold the bracket in position.

B. With the bracket lined up again, place a rivet through the bracket and hole with the long stem sticking outward - shown to the right. The rivet may require a few twists while pushing it in.

C. Check to be sure your rivet gun has the **3/16"** rivet head installed, then slide rivet gun onto rivet. While applying downward force on rivet and bracket, firmly squeeze riveter handle multiple times until rivet gun pops and snaps off the rivet stem.



Riveting Tips:
Visit <http://www.redlinetuning.com/QL-tips.html>

Step 7 - Drill and rivet 2nd hole

A. Reposition or rotate bracket into the proper position against hood lip. Carefully drill the second hole through bracket hole and hood frame.

Wrap end of drill bit 1/4" down from tip with electrical tape to keep drill bit from pulling through and hitting hood skin.



Step 8 - Repeat steps 3-7 and install the passenger side hood bracket.

- A. The hood has a symmetrical under structure. Repeat Steps 3-7 to install the upper passenger hood bracket.
- B. Remove rubber bumper located on either side of fender lip - this bumper sits right where the gas spring will be lying when the hood is closed.

Step 9 - Position and mark first hole for driver's side fender bracket.

- A. Hold the bracket in position as shown to the right. The bracket should sit with the edge of the bracket close to the fender hole, while the centerline of the bracket is aligned with the mark made on the fender tape. The ball stud should be pointing inward or toward the vehicle and tucked up tightly against the inner fender.



Copyright © 2003 Redline Tuning LLC. All Rights Reserved.

Step 10 - Mark hole center before drilling upper or right hole using 3/16" drill bit.

- A. Using a center punch and a hammer, tap the center of the marked hole. This will help guide the drill bit and keep it from wandering during the following step.
- B. Drill the upper or right hole at the marked position using a sharp **3/16" drill bit**.



Copyright © 2003 Redline Tuning LLC. All Rights Reserved.

Step 11 - Attach the upper or right end of the bracket to fender.

- A. Using a color matching paint, touch up the area where you just drilled the hole.
- B. Rivet the bracket into place as described in an earlier step.



Copyright © 2003 Redline Tuning LLC. All Rights Reserved.



Copyright © 2003 Redline Tuning LLC. All Rights Reserved.



Copyright © 2003 Redline Tuning LLC. All Rights Reserved.

Step 12 - Mark center with marker and indent with center punch.

- Using a permanent marker, mark the left or lower hole of the fender bracket. **Be sure the bracket is tucked up tightly to the fender lip.**
- Using a center punch and a hammer, tap the center of the marked hole. This will help guide the drill bit and keep it from wandering.

Step 13 - Drill second hole and attach bracket.

- Carefully drill the hole as shown to the right using a **3/16" bit**. Drill through both bracket and fender lip, you do not need to move the bracket to drill.
- Rivet bracket into place.



Step 14 - Repeat steps 9-13 to attach the passenger fender bracket.

- Repeat Steps 9-13 to attach the passenger side fender bracket. The vehicle is symmetrical so the same locators can be used. Feel free to measure off of key areas to ensure a symmetrical installation.

Step 15 - Cycle both gas springs - then install

- CYCLE EACH GAS SPRING BEFORE INSTALLING** - firmly hold a gas spring with both hands by the thick cylindrical end - firmly press down on the floor or carpet and compress the spring. Do this to both springs. Have a friend hold the hood up. Remove the stock prop rod assembly at this time.
- Install the driver's side gas spring with the cylinder at the top (large end up). Be sure that the sockets snap securely onto the ball studs. This procedure is most easily done if the hood ends are snapped on first and attach the lower fender ball studs last. Photos may not represent the gas spring direction indicated here.

